

# The differences within the Lammin® window and door families, and the colour definitions used

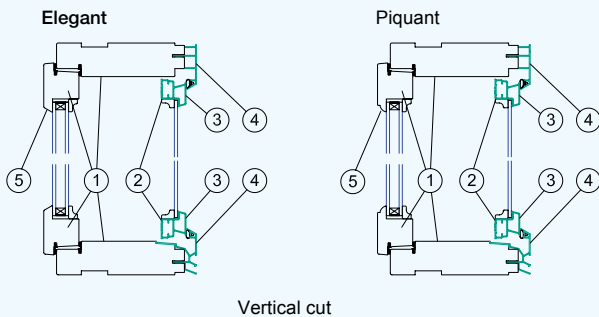

Windows & Doors



Colour ①	Colour ②	Colour ③	Colour ④
Inner sash and frame to the inside	Outer sash to the inside	Outer sash to the outside	Frame to the outside

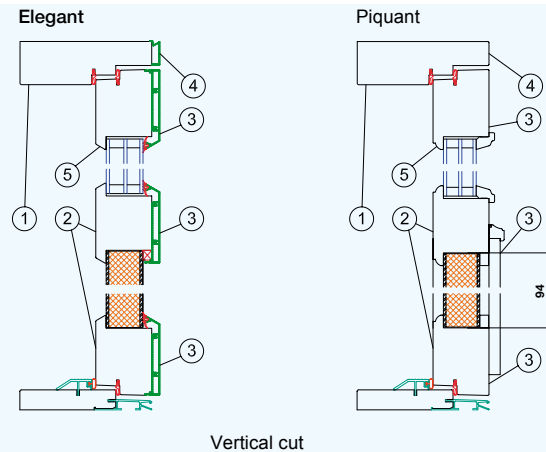

Colour ①	Colour ②	Colour ③	Colour ④
Frame to the inside	Door leaf to the inside	Door leaf to the outside	Frame to the outside

⑤ Difference between model series: Elegant = bevelled shape Piquant = decorative shape

## Colours of wooden parts

Pigment finish: Standard paint colour of NCS 0502-Y (Rakpuu white).

Translucent coating: Teknos translucent colours in accordance with the colour chart, including water-diluted varnish for the inner surface of the inner sash in the standard delivery.

All other finishes and colours are available by special order. The outer sash of a wooden window can have a different colour than the frame. Also, the inner and outer surface of the outer sash can be of different colours.

## The colour of the aluminium profiles

Standard aluminium profile colours are RAL 9010, RR 21, RR 23, and RR 32.

Other RR and RAL tones are available on request. The inner and outer surface of the outer sash of a compound window can be of different colours.

The threshold mouldings of the doors are anodised in the tone of the aluminium.

## The colours of the glazing beads of the windows

The glazing beads of white windows are made of UV protected, body-tinted plastic.

The glazing beads of windows with a translucent coating or special paint colours are wood of the same colour or a body-tinted plastic matching that colour.

## Colours of the glazing-unit spacers for insulation glasses

The glazing-unit spacers for white windows and balcony doors are white. The windows, balcony doors, and all exterior doors with different colour treatments have a clear metallic tone as the standard selection.

In energy glasses and other special glasses, the colour may differ from this.

## Window hinges and surface fittings

The hinges are bolted steel hinges.

- The hinges of the white-painted window are white in the

standard delivery (Fe/JVa).

- The hinges of windows in other colours are provided with translucent zinc plating (Fe/Zn) as the standard treatment.
- By separate order, the hinges can be coated with brass (Fe/Me).

Ventilation-window handles are made of metal.

- The casement handles of the white-painted window use white as the standard selection (Fe/JVa).
- The casement handles of windows in other colours have zinc chrome plating (Fe/Cr).
- By separate order, the casement handles may be made of brass (Ms/Ha), for example.

## Door hinges and surface fittings

Door fittings are described in the product charts.

## Ventilation window grilles

The exterior ventilation window grille is colour-ready, Pural-coated, zinc-coated, steel plate.

- The grille of the ventilation window that is painted white is RR 20 in the standard delivery.
- Other painted colours and translucent coatings are in accordance with the RR standard tone chart.

The order and order confirmation with the product charts cover only the product quantities and quality, surface treatments, and equipment mentioned in them.